



The Right Way™ to attach almost anything to metal roofs!

CorruBracket 500T Installation Instructions

www.S-5.com

888-825-3432

Installation Instructions

S-5!® Warning! Please use these products responsibly! Visit our website or contact your S-5! distributor for available load test results. The user and/or installer of these parts is responsible for all necessary engineering and design to ensure the CorruBracket™ 500T has been properly spaced and configured. **Notice to S-5! users:** Due to the many variables involved with specific panel products, climates, snowmelt phenomena, and job particulars, the manufacturer cannot and does not express any opinions as to the suitability of any S-5! assembly for any specific application and assumes no liability with respect thereto. S-5! products are tested for ultimate holding strength on various profile types and materials. This information is available from the S-5! website: www.S-5.com. This document is an installation guide only and the photographs and drawings herein are for the purpose of illustrating installation, tools and techniques, not system designs. Information contained within is intended to apply to the document as a whole.

CorruBracket 500T is mounted directly into the crest of the corrugation with the recommended sheet metal screws or bulb rivets, or can be mounted directly over and into the supporting structure of the roof, (i.e. wood decking, wood or steel purlins, or trusses).

Tools Needed

- Screw Gun* or Bulb Rivet Gun
- String Line
- Rag
- Tape Measure

*For time saving tool recommendations contact S-5!

Use Proper Hardware

Only use appropriate screws and hardware when attaching this product to the roof sheeting or directly into the supporting structure.

Sheeting Only

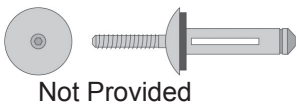

Not Provided

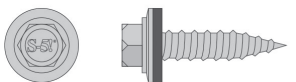

Sold Separately

Check with your distributor for pricing and availability

Rivet Specifications: 9/32" (7.7mm) Diameter - Alu/Alu Flat Head Bulb-Tite Rivet with 5/8" (16mm) EPDM Washer Grip 0.032" - 0.375"/0.8mm - 9.5mm

Screw Specifications: 1/4" (6.3mm) Diameter - 1" (25mm) Length - Stainless Steel Self Tapping Screw with Hardened Steel Piercing Point - 5/16" (8mm) Hex Head - 5/8" (16mm) Stainless Steel / EPDM Sealing Washer

Supporting Structure



Not Provided

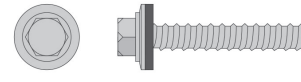

Not Provided

Metal to Metal Screw Specifications: 1/4-14 Self Drilling Screw - 2" Length - 3/8" Hex Washer Head - Zinc/Aluminum Cap

Metal to Wood Screw Specifications: 1/4-14 Type 17-AB Milled Point - 2-1/2" Length - 3/8" Hex Washer Head - Zinc/Aluminum Cap

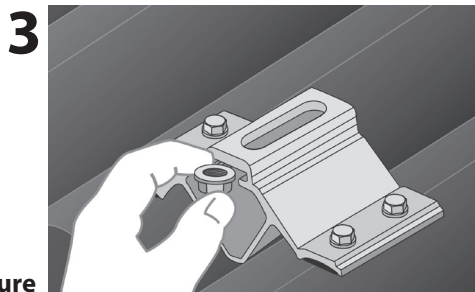
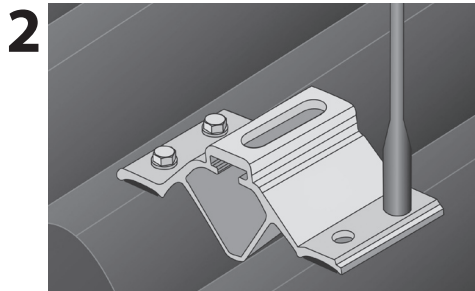
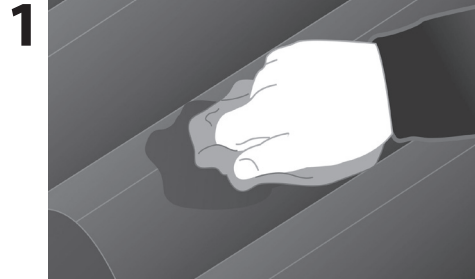

To Install CorruBracket 500T

A) Attaching to roof sheeting

1. The only surface preparation necessary is to simply wipe away excess oil and debris. Refer to (Fig 1).
2. Secure the CorruBracket 500T directly into the crown of the roof profile with the recommended screws via the pre-punched holes, or by pre-drilling the proper-sized hole in the sheeting through the pre-punched holes and riveting with bulb-type rivets (as per rivet manufacturer's installation instructions). To achieve tested holding strength, secure the CorruBracket 500T by using all of the pre-punched hole locations. Drive fasteners until washers are adequately seated and sealed. Refer to (Fig 2).

Note: Do not over-drive fasteners; a slight extrusion of rubber around the washer is a good visual-tightness check. If a fastener has been stripped due to over-driving, it is important to remove the fastener and replace it with a bulb rivet or larger diameter fastener. To avoid stripping, use screw gun with depth-sensing nose piece or adjustable torque clutch.

CorruBracket 500T Installation Instructions

3. From either end of the CorruBracket 500T slide the included M8-1.25 hex flange nut (flange side up) into the top groove (**Fig 3**). The CorruBracket 500T is now ready to install the S-5-PVKIT 2.0 by insertion of the the PV Standoff, or other ancillaries by using a standard M8 bolt through the slotted top thru-hole and the previously inserted hex flange nut. For critical attachment applications utilizing an M8-1.25 X 16 mm Hex Flange Bolt, tighten the M8 bolt to 160 inch pounds (13 foot pounds).

To Install CorruBracket 500T

B) Attaching to supporting structure

1. Determine the location of the supporting structure of the roof. When possible secure the CorruBracket 500T using all of the pre-punched hole locations; when not possible, always use the two upslope hole locations. The only surface preparation necessary is to simply wipe away excess oil and debris. Refer to (**Fig 1**).
2. Secure the CorruBracket 500T by driving appropriate screws through the pre-punched holes and into the supporting structure of the roof. Do not remove the EPDM rubber gasket as this is for weather-proofing. Refer to (**Fig 2a and 2b**).
Note: Do not over-drive fasteners; a slight extrusion of rubber around the washer is a good visual-tightness check.
3. From either end of the CorruBracket 500T slide the included M8-1.25 hex flange nut (flange side up) into the top groove (**Fig 3**). The CorruBracket 500T is now ready to install the S-5-PVKIT 2.0 by insertion of the PV standoff, or other ancillaries by using a standard M8 bolt through the slotted top thru-hole and the previously inserted hex flange nut. For critical attachment applications utilizing an M8-1.25 X 16 mm Hex Flange Bolt, tighten the M8 bolt to 160 inch pounds (13 foot pounds).

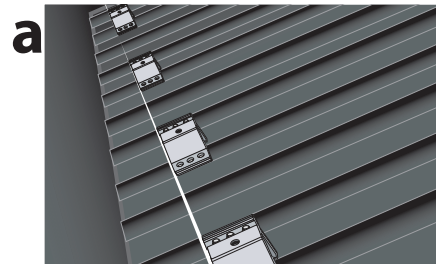
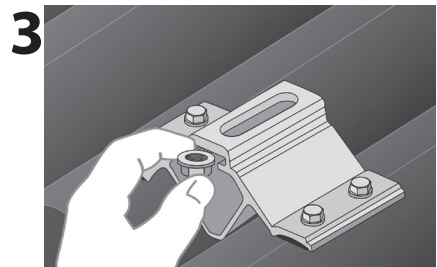
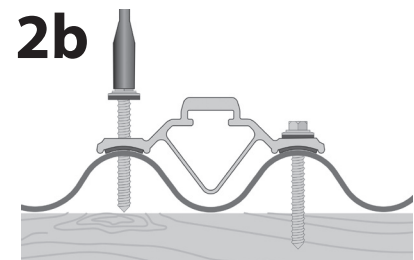
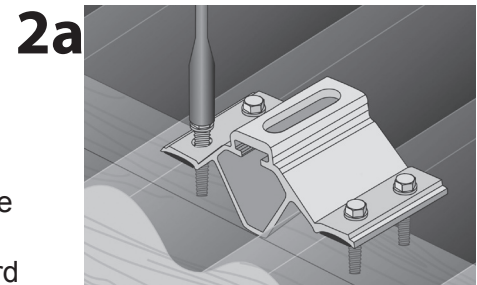
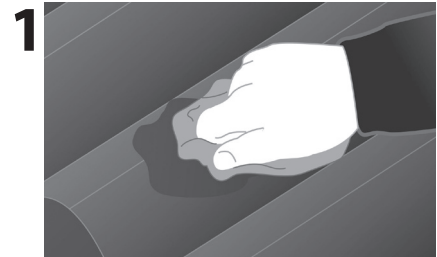

CorruBracket 500T Placement Tips

a) Horizontal bracket alignment

To ensure brackets are installed in a straight line when desired, install a single CorruBracket 500T on each end of the roof at a measured, consistent distance from the bottom edge of the roof. Use a string line between the two brackets. Mount the remaining CorruBracket 500T along the string line, directly into the roof. Refer to (**Fig a**).

b) Upslope bracket spacing

For upslope bracket spacing techniques reference the S-5! website at www.S-5.com

S-5!® Warning! Please use this product responsibly!

Products are protected by multiple U.S. and foreign patents. For published data regarding holding strength, fastener torque, patents, and trademarks, visit the S-5! website at www.S-5.com. Copyright 2018, Metal Roof Innovations, Ltd. S-5! products are patent protected. S-5! aggressively protects its patents, trademarks, and copyrights.

CB500TI-V2.0-0719